

# Cockermouth Town Council



26 April 2021

Dear Sir/Madam,

You are summoned to a special planning meeting of Cockermouth Town Council to be held virtually via Microsoft Teams on **Thursday 6 May 2021 at 7pm** for the purpose of the under-mentioned business.

Please let me know if you are unable to attend.

Yours sincerely,

Sheila Brown

1. **Apologies for absence**
2. **Declaration of Interest** – Members to give notice of any disclosable pecuniary interest, other registrable interest or any other interest and the nature of that interest in relation to any item on the agenda in accordance with the adopted code of conduct.
3. **Public Participation**
  - a) To answer any questions from members of the public in accordance with the Summary of Public Rights
  - b) To receive a petition from a member of the public in accordance with the Summary of Public Rights (if any)
4. **Planning Applications** – To comment on various planning applications received from Allerdale Borough Council (**page 1**)
5. **Tree Works** – To comment upon tree works 26 Strawberry How (**pages 2-11**)

Town Hall, Market Street  
Cockermouth  
Cumbria  
CA13 9NP

Tel:

01900 821869

Fax:

01900 827166

Website:

[www.cockermouth.org](http://www.cockermouth.org)

Facebook:

[@cockermouthtowncouncil](https://www.facebook.com/@cockermouthtowncouncil)

Sheila Brown, *Town Clerk*  
[clerk@cockermouth.org](mailto:clerk@cockermouth.org)

Kirstie Goodger  
[admin@cockermouth.org](mailto:admin@cockermouth.org)

Amy Pattinson  
[assistant@cockermouth.org](mailto:assistant@cockermouth.org)

**Press and Public Welcome**



*Joint Winners*

Council of Europe Year 2000

Europe Prize

*Previous Awards*

Plaque of Honour, Flag of Honour

European Diploma

Reference: **FUL/2021/0080**

Proposal: Change of use of land to allow the siting of 34 Holiday Chalets and Open Space

Location: Violent Bank Caravan Park, Simonscales Lane, Cockermouth, CA13 9TG

Recommended -

Reference: **OUT/2020/0019**

Proposal: Outline application for the erection of 2 detached dwellings with access

Location: Land Adjacent to, Colinwood, Brigham Road, Cockermouth, CA13 0AX

Recommended -

Reference: **FUL/2021/0116**

Proposal: Install new windows

Location: 20 Lorton Street, Cockermouth, CA13 9RH

Recommended -

Reference: **HOU/2021/0107**

Replacement of existing windows

4 New Street

Recommended –

Reference: **FUL/2021/0059**

Replacement windows and external doors

1-6 Green Yard, Derwent Street

Recommended –

Reference: **FUL/2021/0104**

Conversion of bungalow into two separate bungalows with new access

School Gardens, Cockermouth

Recommended -

Sp pl.  
Agenda Item 5

## Assistant - Cockermouth TC

---

**From:** Clerk - Cockermouth TC  
**Sent:** 21 April 2021 07:55  
**To:** Assistant - Cockermouth TC  
**Subject:** FW: Planning Application WTPO/2021/0015

Please print off and put on my desk for special planning

**Sheila Brown**  
The Town Clerk  
Cockermouth Town Council  
The Town Hall  
Market Street  
Cockermouth  
Cumbria  
CA13 9NP

Tel: 01900 821869  
[www.cockermouth.org](http://www.cockermouth.org)  
[clerk@cockermouth.org](mailto:clerk@cockermouth.org)  
Facebook @CockermouthTownHall

### Confidentiality Statement

This document is intended for, and should only be read by, those persons to whom it is addressed. Its contents are confidential and if you have received this message in error, please notify us immediately by telephone and delete all records of the message from your computer. Any form of reproduction, dissemination, copying, disclosure, modification, distribution and / or publication of this message without our prior written consent is strictly prohibited. Neither the author of this message nor their employers accept legal responsibility for the contents of the message. Any views or opinions presented are solely those of the author.  
For further information please visit our website: <https://www.cockermouth.org/wp-content/uploads/2018/06/Email-Contact-Privacy-Notice.pdf>

---

**From:** Lesley Currie <lesley.currie@allderdale.gov.uk>  
**Sent:** 20 April 2021 16:33  
**To:** Clerk - Cockermouth TC <clerk@cockermouth.org>  
**Subject:** Planning Application WTPO/2021/0015

Dear Sir/Madam

Consultation on planning application

Reference No: WTPO/2021/0015

Applicant: Emma Jane Todhunter

Proposal: Portuguese Laurel - Overhanging garden - remove some height from the tree and thin out

Location: 26, Strawberry How, Cockermouth, CA13 9XZ

I would be grateful if you could use the link below to view the above planning application. By inputting the above reference number it will display the application for you to view. Please indicate any observations you/your department may have by e-mail to [planning@allerdale.gov.uk](mailto:planning@allerdale.gov.uk) or by separate letter.

In order to ensure that applications are dealt with as quickly as possible I would be grateful if you could reply by 11/05/2021. Representations received after this date may be too late to influence the Local Planning Authority's decision on this application.

Could you please mark any correspondence for the attention of Kerry McCartney and could you please quote the reference number WTPO/2021/0015.

Please note that all the information contained in this application can be viewed by the public and on our website

<https://allerdalebc.force.com/pr/s/planning-application/a3X3X000007zK7vUAE>

Yours faithfully

Kerry McCartney

Planning Officer



STRAWBERRY HOW ROAD

Boundary of Iron Quarry

WOODLAND

25

26

27

KEY

\* TREE  
T63/T71 or T72 ??

Strawberry How, Cockermouth.  
Site Plan.

1 625 Date October, 2005

5/1STRAb

Boundary of  
"Iron Number"  
C 15:527



5



STRAWBERRY HOW ROAD

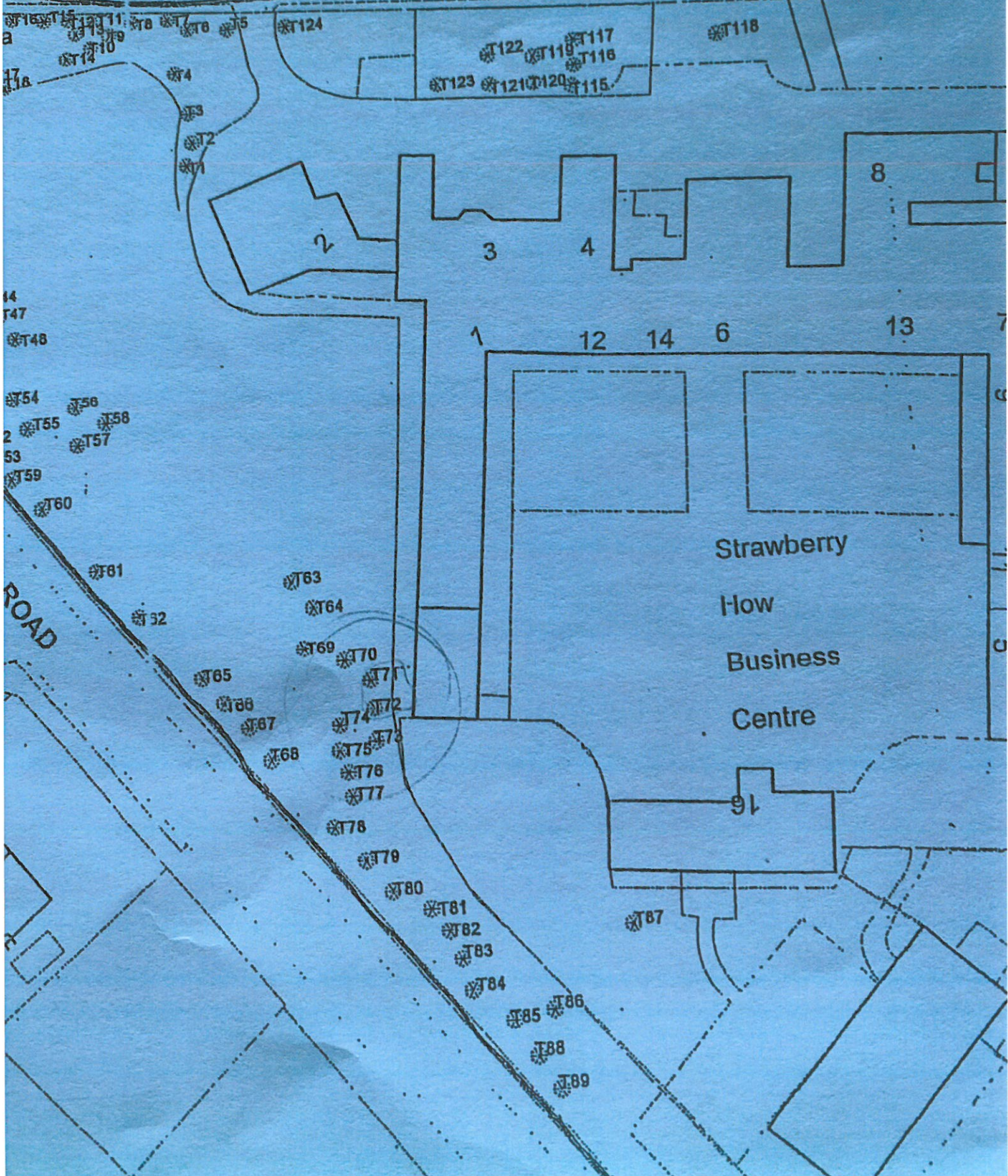



Application for tree works: works to trees subject to a tree preservation order (TPO) and/or notification of proposed works to trees in a conservation area.

Town and Country Planning Act 1990

**Publication of applications on planning authority websites.**

Please note that the information provided on this application form and in supporting documents may be published on the Authority's website. If you require any further clarification, please contact the Authority's planning department.

**1. Trees Location**

Number	26
Suffix	
Property name	
Address line 1	Strawberry How
Address line 2	
Address line 3	
Town/city	Cockermouth
Postcode	CA13 9XZ

If the location is unclear or there is not a full postal address, describe as clearly as possible where it is (for example, 'Land to rear of 12 to 18 High Street' or 'Woodland adjoining Elm Road')

Easting (x)	312918
Northing (y)	529880

Description

**2. Applicant Details**

Title	Miss
First name	Emma Jane
Surname	Todhunter
Company name	
Address line 1	26
Address line 2	
Address line 3	

## 2. Applicant Details

Town/city	COCKERMOUTH
Country	
Postcode	CA13 9Zx
Are you an agent acting on behalf of the applicant?	<input type="radio"/> Yes <input checked="" type="radio"/> No
Primary number	
Secondary number	
Fax number	
Email address	

## 3. Agent Details

No Agent details were submitted for this application

## 4. What Are You Applying For?

Based on the type of work proposed and the location and protected status of the trees involved, there are various details and supporting information that will need to be supplied in order for the Local Planning Authority to determine the application.

Are you seeking consent for works to tree(s) subject to a Tree Preservation Order?  Yes  No

Do you know the Tree Preservation Order reference number(s)  Yes  No

Please enter the title or number for each relevant Tree Preservation Order

It is a Portuguese Laurel but I am not sure if it is T63, T71 or T72 off the map...sorry.

### For works to trees covered by a TPO

Please indicate whether the reasons for carrying out the proposed works include any of the following. If so, your application MUST be accompanied by the necessary evidence to support your proposals (see guidance notes for further details).

1. Condition of the tree(s) - e.g. it is diseased or you have fears that it might break or fall  Yes  No

2. Alleged damage to property - e.g. subsidence or damage to drains or drives.  Yes  No

Are you wishing to carry out works to tree(s) in a conservation area?  Yes  No

### Documents and plans (for any tree)

A sketch plan clearly showing the position of trees listed in the question 'Identification of Tree(s) and Description of Works' MUST be provided when applying for works to trees covered by a Tree Preservation Order. A sketch plan is also advised when notifying the LPA of works to trees in a conservation area (see guidance notes).

It would also be helpful if you provided details of any advice given on site by an LPA officer.

Are you providing additional information in support of your application (e.g. an additional schedule of work for question 'Identification of Tree(s) and Description of Works')?  Yes  No

## 5. Identification of Tree(s) and Description of Works

Please identify the tree(s) and provide a full and clear specification of the works you want to carry out.

You might find it useful to contact an arborist (tree surgeon) for help with defining appropriate work.

Where trees are protected by a Tree Preservation Order, please number them as shown in the First Schedule to the Tree Preservation Order where this is available. You should use the same numbering on your sketch plan (see help for sketch plan requirements).

Please provide the following information:

- Tree species
- The number used on the sketch plan); and
- A description of the proposed works.

Where trees are protected by a Tree Preservation Order you must also provide:

- Reasons for the work; and where trees are being felled
- Proposals for planting replacement trees (including quantity, species, position and size) or reasons for not wanting to replant.

## 5. Identification of Tree(s) and Description of Works

e.g. Oak (T3) - fell because of excessive shading and low amenity value. Replant with one standard ash in same position.

Portuguese Laurel (in the woodland at the back of number 26 Strawberry How hanging over into my garden) this is over grown and blocking light into my house and number 25. I do like the tree but would like permission to take some height and thin the tree out. I am not sure on the map if it's T63 or T71 or T72... sorry!

## 6. Tree Ownership

Is the applicant the owner of the tree(s)?

Yes  No

If No, please provide the address of the owner (if known and if different from the tree location):

### Name/Company

Title:

First name:

Surname:

Company name:

### Address

Number

Suffix

Property name

Address line 1

Address line 2

Address line 3

Town/city

Postcode

### Contact Details

Primary number

Secondary number

Fax number

Email address

## 7. Authority Employee/Member

With respect to the Authority, is the applicant and/or agent one of the following:

- (a) a member of staff
- (b) an elected member
- (c) related to a member of staff
- (d) related to an elected member

It is an important principle of decision-making that the process is open and transparent.

Yes  No

For the purposes of this question, "related to" means related, by birth or otherwise, closely enough that a fair-minded and informed observer, having considered the facts, would conclude that there was bias on the part of the decision-maker in the Local Planning Authority.

Do any of the above statements apply?

## 8. Trees - Declaration

I/we hereby apply for planning permission/consent as described in this form and the accompanying plans/drawings and additional information. I/we confirm that, to the best of my/our knowledge, any facts stated are true and accurate and any opinions given are the genuine opinions of the person(s) giving them.

Date (cannot be pre-application)

10/04/2021